

Topaz Zephyr

27.6 M - Crew Boat

Vessel Specifications



Vessel Specifications

Registration

Year build	2011
Flag / Port of Registry	Marshall Islands / Majuro
Class	DNV + 1A1 HSLC R3 CREW

Dimensions

Length overall	27.6 m
Beam	7.5 m
Depth moulded	3.0 m
Draft	1.35 m

Machinery

Main engine	2 x Caterpillar C32, 'D' rating, 1193 kW @ 2300 rpm
Generator sets	2 x Caterpillar C4.4, 69 kW @ 1500 rpm 50 hz
Propulsion	2 x Hamilton HM651 water jets
Gearbox	2 x Twin Disc MGX-6690 SC

Deck equipment

Anchor	1 x HHP Anchor 117 kgs
Windlass	1 x Maxwell VW4000 24VDC
Bollards	Double Bit type - 08 nos
Marine deck crane	Effer 155 4S 3 t @ 4.4 m, 0.9 t @ 12.2 m

Performance

Top speed	30 knots
Maximum continuous speed	25 knots
Economical speed	20 knots

Capacities

Fuel oil	2 x 6,500 liters in integral aluminum tanks
Fresh water	2 x 2,500 liters in non-integral aluminum tanks
Sullage	1 x 1,000 liters in non-integral aluminum tanks
Deck load capacity	10 t
Deck loading	3 t / m ²
Deck area	53 m ² and mounting for 20' ISO container

Communications

GMDSS radio	SAILOR SP3520
Fleet broad band	Thrane & Thrane FBB 150
SSAS + LRIT	Thrane & Thrane
PA system	Raymarine - including 4 internal speakers & 2 external horn speakers
Satellite TV	Coastal 24
Talk back system	1 x Zenitel

Navigation

Radars (2)	1 x Radar Sperry, 1 x Radar Koden MDC-2510
ECDIS	1 x PC Maritime
AIS	1 x Jotron AIS TR2500
Thermal camera system	1 x Nightnav NV102
GPS	Koden - KGP913
Anemometer	1 x R M Young
Chart plotter	1 x Koden - GTD150
Search lights	3 x Francis A2528 L300RC 220V 1 kW RC
Echo sounder	1 x JMC F3000W
Magnetic compass	1 x Saura
Gyro compass	1 x Sperry
Navtex receiver	1 x NT2000
Autopilot	1 x Navitron NT888G
Inclinometer	1 x Cassens & Plath
Barometer	1 x Aneroid 180 mm

Vessel Specifications

Safety & fire fighting

Life rafts	2 x 25 persons
Life jackets	41 x adult life jackets
Life buoys	2 x life buoys - SOLAS approved 2 x life buoys with signal lights - SOLAS approved 2 x life buoys with signal lights and smoke signals
Breathing apparatus	6 x EEBD, 15-20 minutes
Dacoon scoop	1 no - Starboard side
EPIRB	1 x SRC - Korea
H2S detection system	1 x 4 channels - Honeywell - Touch Point model
First aid kit	1 no
Boat hook	1 no
Bell	1 x 20 cm
Co2 system	1 x fixed Co2 system @ 128 m ³
Portable fire extinguisher	6 x 5 kg Co2 fire extinguisher 4 x 6 kg DCP fire extinguisher
Fireman outfit	1 x fireman suit with SCBA sets
Fire detection and alarm	1 x fixed fire detection system (4 zones)
FiFi pump	PTO driven centrifugal - 600 m ³ / hr
Emergency fire pump	1 x 15 m ³ @ 35 m
FiFi monitor	Water monitor SS150EL
International shore connectors	2 nos
CCTV	1 x each engine room 2 x passenger space monitored from bridge 2 channel systems

Accommodation

Crew + catering	8 persons
Passengers	39 seats
Bunks	4 nos 2 x 2 berth officer cabins 2 x 2 berth crew cabins

All passengers and accommodation spaces are fully air-conditioned and equipped with satellite television.

Last revision Feb 2014

GA Specifications - Topaz Zephyr (24 Hour Boat)

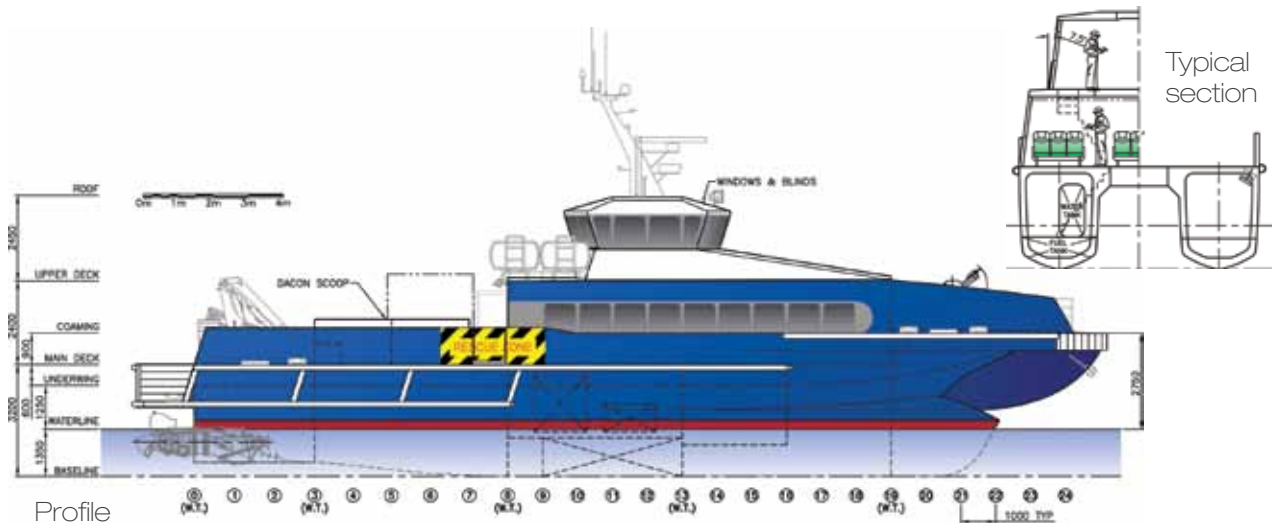

Profile

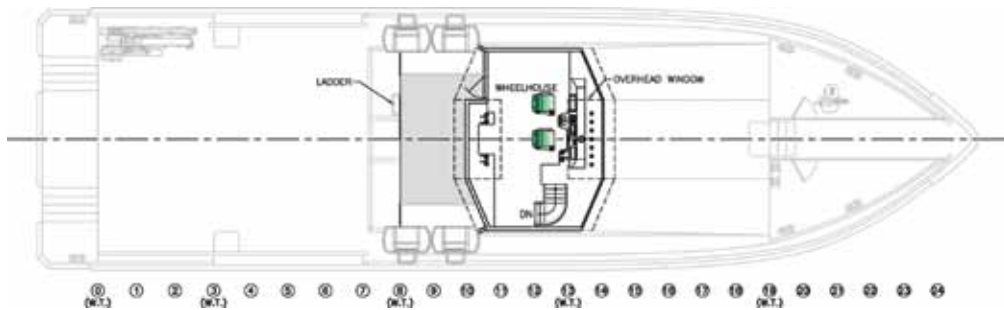

Upper deck plan

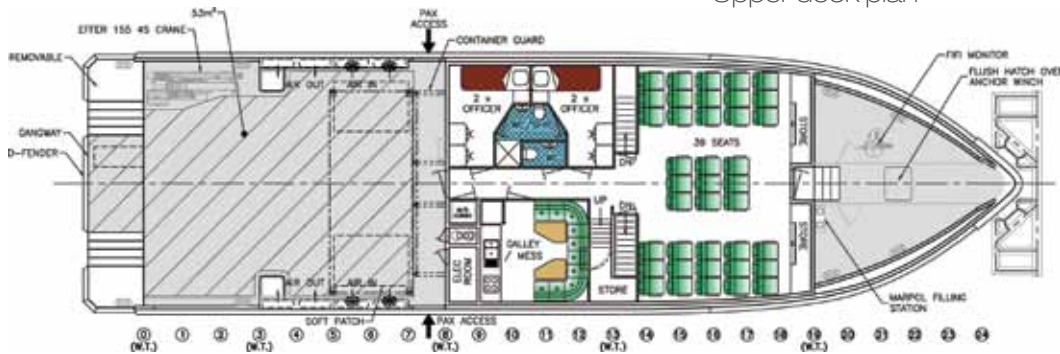

Main deck plan

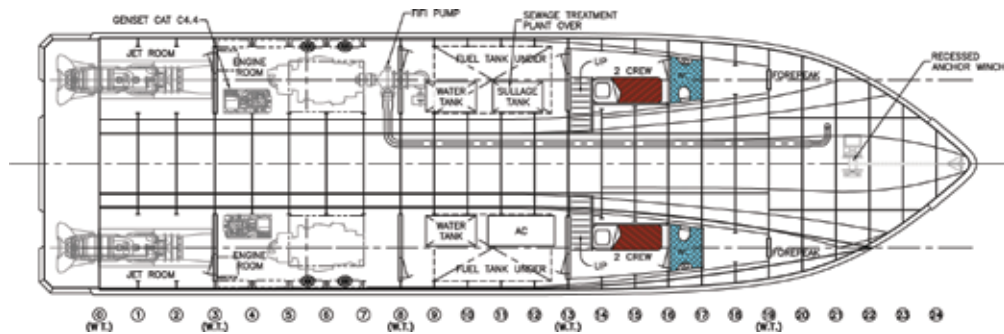

Hull plan

Principal dimensions

Length (LOA)	27.6 m	Deck area	53 m ² and mounting for 20' ISO container
Beam	7.5 m	Speed	32 knots
Draft	1.35 m	Personnel	39 seats
Engines	2 x Caterpillar C32	Construction	Aluminium - hull and superstructure
Rating	1193 kW @ 2300 rpm	Classification	+ 1A1 DNV HSLC R3 CREW
Deck cargo	10 t @ 3 t / m ²		



Navmaster, ECDIS 700

Intelligent Navigation Solutions

Navmaster ECDIS is an established electronic chart display and information system, incorporating the input of many navigators into its design over more than ten years.

Features

- Excellent route planning and detailed passage plan documentation
- Remote diagnostics feature for rapid and low-cost support
- Up-to-date chart installation and updating processes
- Option for radar video overlay



Nightnav NV1020

Thermal imaging & ultra low light vision system

Features

- Economical, rugged and easy to use
- State-of-the-art high resolution thermal imager
- Ultra low light camera
- High quality imaging in any lighting & environmental conditions

Applications

- Situational awareness
- Object avoidance
- Aid to mariners
- Navigation / search and rescue
- Environmental monitoring
- Security / law enforcement
- All weather key asset protection



Vision Master FT 250 Integrated Tabletop

The new, fully type approved integrated tabletop version with radar, chart radar and ECDIS provides all the standard features and capabilities.

Features

- Available system configurations: radar, chart radar, ECDIS and ECDIS with radar overlay and TotalWatch (multifunction)
- Seamless integration of all available configurations for improved watchkeeping
- Comprehensive range of tools and features for the navigator
- Simple user interface
- Comprehensive help information including the innovative iHelp feature
- Fully type approved to the new international type approval standards of IEC 62388 and IEC 62288
- Built-in capability for upgrade path to different system configurations
- Radar systems available in a comprehensive range of antenna/transceiver configurations
- Direct compatibility with existing BridgeMaster E and BridgeMaster II top units



Koden MDC 2510 Marine Radar

High performance and multi-function Koden Marine Radars with 15' color TFT LCD

Features

- True trail function makes easy to distinguish moving from stationary objects
- ATA (Automatic Tracking Aid) with up to 50 targets showing latest information of other vessels ensuring safe navigation
- AIS interface up to 200 targets
- Map overlay with C-Map chart to provide clear radar pictures of coastline and bouys
- Dual station
- Interference rejection
- Target expansion

CONTACT

Commercial Department
Topaz Energy and Marine
Level 58, Almas Tower, Jumeirah Lakes Towers
P.O. Box 282800, Dubai, UAE
Tel +971 4 440 47 00
Fax +971 4 440 47 99
Email marketing.topaz@topaz-marine.com

Topaz Marine Divisional Office
Nico Middle East Ltd.
P.O. Box 261005, Building 33
Oilfields Supply Centre
Jebel Ali Free Zone, Dubai, UAE
Tel +971 4 883 29 29
Fax +971 4 883 29 59
Email marketing.mena@topaz-marine.com

Topaz Marine Azerbaijan
BUE Caspian Ltd.
3rd Floor, Gurban Khalilov Street 3
Yasamat District, Baku
AZ1006 Azerbaijan
Tel +994 124 97 87 67
Fax +994 124 97 25 96
Email topazmarine.azn@topaz-marine.com

Topaz Marine Kazakhstan
BUE Kazakhstan Limited
1st Floor, 36A, Vystavochniy Business Center
14 Micro Region, Aktau
130000 Kazakhstan
Tel +772 92 42 82 72
Fax +772 92 42 82 77
Email tmkzh.aktauoffice@topaz-marine.com

Topaz Marine MENA
Doha Marine Services WWL
P.O. Box 37102, 4th Floor, Faisaliyah Building
Suhaim Bin Hamad Street, Al Sadd Area
Doha, State of Qatar
Tel +974 4410 48 00
Fax +974 4447 94 73
Email marketing.mena@topaz-marine.com