

Caspian Protector

61 M - 5080 BHP - DP 1 - ERRV

Vessel Specifications

TOPAZ
MARINE



Vessel Specifications

General

Type	Emergency response and rescue vessel
Flag	Azerbaijan
Class	ABS XA1, X AMS, Fi-Fi Class 1 and DPS-1, safety-standby A-300
Year of build	2010
Place of build	Berjaya, Malaysia
Port of registry	Baku
Call sign	4JOA
IMO number	9565027

Dimensions

Length overall	61.25 m
Length between perpendicular	58.7 m
Breadth moulded	16 m
Depth moulded	6 m
Draft summer / scantling	4.5 m
Deadweight	1000 t
Net registered tonnage	632 t
Gross tonnage	2108 t

Machinery

Main engines	2 x Caterpillar 1894 kw (3788 kw)
Main generators (shaft driven)	2 x 1000 kw / 440 v / 3 ph / 60 hz
Main generators (diesel driven)	2 x 405 kw / 440 v / 3 ph / 60 hz
Emergency generator	1 x 80 kw / 440 v / 3 ph / 60 hz
Bow thruster	2 x CPP tunnel (1 x 8 t, 1 x 6 t)
Stern thruster	1 x 8 t CPP tunnel
Propulsion	2 x CPP tunnel (in nozzles)
Rudders	High lift 350 flap type rudders
Steering gear	Kobelt

Mooring Equipment

Anchor windlass	1 x Plimsoll 10 t double gypsy
Bow anchors	2 x AC14 anchors each 1575 kg
Chains	2 x 330 m x 38 diameter, grade 3
Capstan	PC-HVC-0, 2 x 5 t

Ancillary equipment

Sewage treatment plant	CWNKL-0233-08 / Korea
Oily water separator	QRS_1OE / 15 ppm
Freshwater maker	Yes

Deck Crane

Manufacturer	1 x McGregor
SWL and radius	2 t x 12 m
Location	Aft mid ship / m. deck

Towing and anchor handling equipment

Towing / AH winch	1 x electro-hydraulic
Wire capacity	1000 m FSWR
Rated pull (1st layer)	60 t
Brake holding	150 t
Stern roller	Fitted, water lubricated
Shark jaws	160 t SWL assembly comprising 2 jaws
Tow pins	160 t SWL assembly comprising 2 pins
Tugger winch	2 x 10 t
Bow fendering	Heavy duty 600 mm x 300 mm

Vessel Specifications

Performance

Maximum speed / consumption	14 knots / 16 t
Economical speed / consumption	10 knots / 5.5 t
Consumption at 100%	MCR 17.5 t
Bollard pull	60 t

Capacities

Fuel oil	500 m ³
Potable water	280 m ³
Ballast / drill water	730 m ³
Deck strength	5 t per m ²
Clear deck area m ²	364 m ²
Clear deck area max L x B	28 m x 13 m

Transfer Rates

Fuel	73 m ³ per hr @ 18 bar
Freshwater	100 m ³ per hr @ 15 bar
Drill water / ballast water	60 m ³ per hr @ 9 bar
Bilge / ballast	60 m ³ per hr @ 9 bar
GS / fire pump	40 m ³ per hr @ 13.5 bar

Communication and navigation equipment

GMDSS station	Area 3, Inmarsat C, Thrane & Thrane
Satcom and type	VSAT
SSB	Thrane & Thrane
Aero VHF	1 x Furuno
AIS	Furuno FA-150
EPIRB	Jutron Tron 40S
Radar transponder	2 x Saracom
Two-way portable VHF / UHF	8 x VHF 5 x UHF
Navtex receiver	1 x Navtex NX-700 A / B
DP system	Converteam DP 1
DP reference systems	2 x Veripos DGPS 1 x Cyscan
Radar 1	1 x Furuno 10 cm
Radar 2	1 x Furuno 3 cm
Gyro compass	2 x Raytheon ST22
Auto pilot	Raytheon NP60
GPS receiver	1 x Furuno GL-150
Echo sounder	1 x Furuno FE-700
Doppler speed log	1 x Walker type 4020
Anemometer	1 x Gill instruments

Fire fighting and anti-pollution equipment

FiFi system	FiFi 1
Fire pump	2 x 1500 m ³ per hr
Monitors	2 x 1200 m ³ per hr
Drenching system	Fitted
Oil dispersant system	2 booms fitted
Oil dispersant storage tank	14 m ³
Emergency fire pump	40 m ³ x 60 m
Locker with fireman's outfit	3 x lockers 14 set SCBA
Portable FiFi applicances	18 x fire extinguishers 11 x hoses
CO2 system for engine room	Yes

Vessel Specifications

Safety equipment

Life rafts	6 x 25 men
Fast rescue boat	2
Rescue boat davit	2 x heave compensated
Daughter craft	3 x MP1111
Daughter craft davit	3 x heave compensated
Life jackets	42 plus 6 spares
Immersion suits	27
Rescue basket	1
Dacon scoop	1
Embarkation ladders	3

Accommodation

Max per LSA	39
1 berth cabins	15
2 berth cabins	6
Sick bay / hospital	Yes

Survivor Accommodation

Reception area	1 x 5 men
Treatment room	1
Sanitary facilities	Yes
Recovery area	1 x 26 berths
Rescue command centre	In wheelhouse
Survivor seating	66 seats
Total survivor capacity	300
Mortuary	Yes

Last revision May 2013

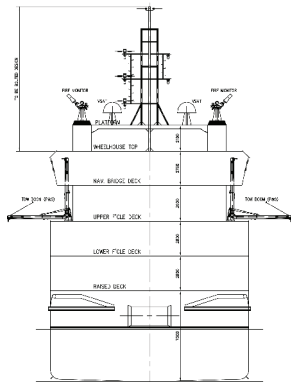

Section looking forward

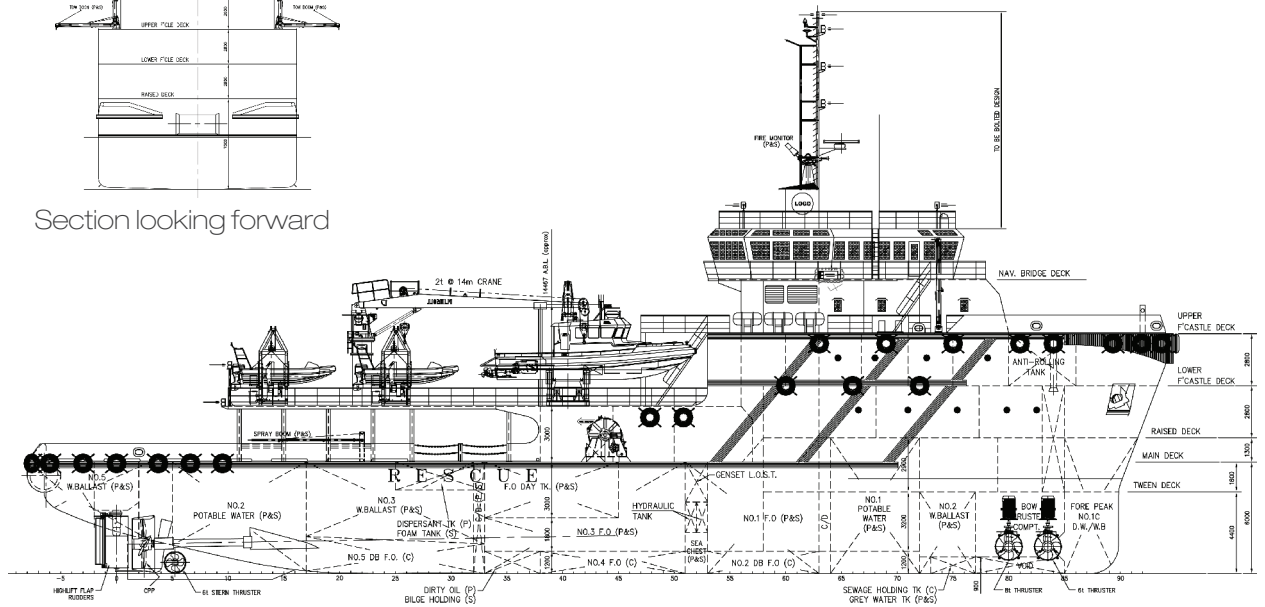

Outboard profile

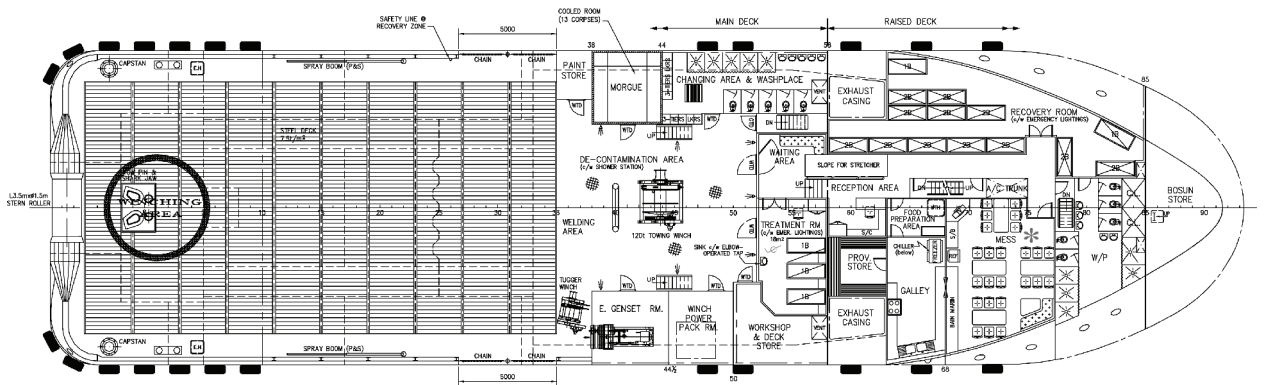

Main deck

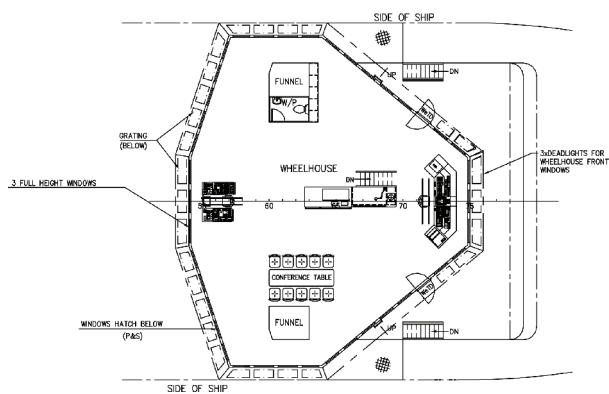

Nav bridge deck

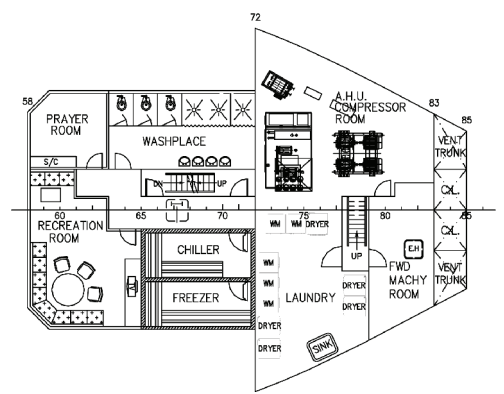

Accommodation tween deck

CONTACT

Commercial Department
Topaz Energy and Marine
Level 58, Almas Tower, Jumeirah Lakes Towers
P.O. Box 282800, Dubai, UAE
Tel +971 4 440 47 00
Fax +971 4 440 47 99
Email marketing.topaz@topaz-marine.com

Topaz Marine Divisional Office
Nico Middle East Ltd.
P.O. Box 261005, Building 33
Oilfields Supply Centre
Jebel Ali Free Zone, Dubai, UAE
Tel +971 4 883 29 29
Fax +971 4 883 29 59
Email marketing.mena@topaz-marine.com

Topaz Marine Azerbaijan
BUE Caspian Ltd.
3rd Floor, Gurban Khalilov Street 3
Yasamat District, Baku
AZ1006 Azerbaijan
Tel +994 124 97 87 87
Fax +994 124 97 25 96
Email topazmarine.azn@topaz-marine.com

Topaz Marine Kazakhstan
BUE Kazakhstan Limited
1st Floor, 36A, Vystavochniy Business Center
14 Micro Region, Aktau
130000 Kazakhstan
Tel +772 92 42 82 72
Fax +772 92 42 82 77
Email tmkzh.aktauoffice@topaz-marine.com

Topaz Marine MENA
Doha Marine Services WWL
P.O. Box 37102, 4th Floor, Faisaliyah Building
Suhaim Bin Hamad Street, Al Sadd Area
Doha, State of Qatar
Tel +974 4410 48 00
Fax +974 4447 94 73
Email marketing.mena@topaz-marine.com