

red husky

AZIMUTH STERN DRIVE
OCEAN GOING
TERMINAL
ESCORT
OIL RECOVERY
AHT
DP I



REPASA

REMOLCADORES DE PUERTO Y ALTURA, SA

Muelle de Reus, sn • 43004 TARRAGONA (SPAIN)
Phone +34 977 25 25 65 • Fax +34 977 22 93 52 • repasa@repasa.net • www.repasa.net

red husky

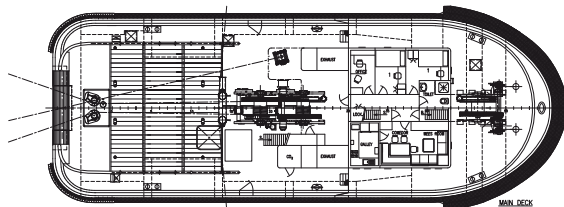
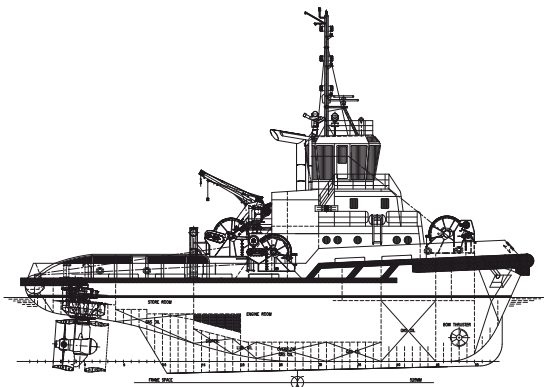

OWNER / OPERATOR REMOLCADORES DE
PUERTO Y ALTURA, SA - REPASA
Balenciaga S.A., Zumaia, Spain

YARD Balenciaga S.A., Zumaia, Spain

COMPLETED Jan 2010

CAPABILITIES Open Sea Towing
Harbour & Terminal Tug
Escort
DPI
A.H.T.
Oil Recovery Vessel

CLASS Germanischer Lloyd
+ 100 AS Active Escort Tug,
Oil Recovery Vessel,
+ MC AUT, FFI I
GL No 113903

FLAG / HOME PORT Spanish / Santa Cruz de Tenerife

CALL SIGN E.A.J.H.

OFFICIAL NUMBER 19/2009

IMO NUMBER 9440356

MMSI NUMBER 224094000

SATELLITE TELEPHONE +870 773 153 762

SATELLITE FAX +870 783 156 326

INMARSAT C (1) 422409410@c12.stratosmobile.net

INMARSAT C (2) 422409411@c12.stratosmobile.net

GSM TELEPHONE / FAX +34 608 57 63 31

E-MAIL redhusky@repasa.net

DIMENSIONS

LENGTH OVERALL 33,00 m.

LENGTH B.P. 28,65 m.

BREADTH 12,00 m.

DEPTH MLD. 5,60 m.

DRAFT MLD. 4,30 m.

G.T. / N.T. 478 / 143

DISPLACEMENT (MAX.) 1.123

ENGINES

MAIN ENGINES MAN B&W 7L27/38
K.W. / B.H.P. 2 x 2.380 kw (4.760 Total)
6.470 B.H.P. @ 800 rpm

AUX. ENGINES 2 x CAT 9A1-up
K.W. 2 x 162 kw, 380 volt. 50 hz.
(200 KVA)

PROPULSION

PROPELLERS WÄRTSILA (Azimuth thrusters)
TYPE CS 275 (2.800 mm. diam.) CPP

BOW THRUSTER FLUIDMECANICA
TYPE HMH-950 (450 bhp) 5 tons. pull

PERFORMANCE

BOLLARD PULL AHEAD 88 tons

BOLLARD PULL ASTERN 80 tons

FREE RUNNING SPEED AHEAD 14,00 knots

FREE RUNNING SPEED ASTERN 12,50 knots

ESCORT STEERING FORCE 93 tons @ 8 kts.
115 tons @ 10 kts.

CAPACITIES

FUEL OIL 248 / 233 c.m.

LUBE OIL 3 c.m.

HYDRAULIC OIL 3 c.m.

DIRTY OIL 3 c.m.

FRESH WATER 42 c.m.

DISPERSANT 9 c.m.

FOAM 24 c.m.

RECOVERY OIL 60 c.m. in two tanks
with heating coils

DECK SPACE 85 sq. m. (10 m. x 8,5 m.)

DECK STRENGTH 5 tons/sq.m. all over

DECK LOAD CAPACITY 36 tons.

CONSUMPTION

IN PORT 0,4 c.m.

STAND BY 1,5 c.m.

ECONOMIC SPEED (10 kts) 7,0 c.m.

MAXIMUM SPEED (13,5 kts) 12,0 c.m.

TOWING (6-7 knots) 12,0 c.m.

TOWING EQUIPMENT

TOWING WINCH FORWARD 115 tons pull
200 tons brake, + anchor windlass
Hydraulic 80 t. pull
200 t. brake. Waterfall type

TOWING WINCH AFT Hydraulic 6 tons pull / 15 tons brake
1 x 200 m. Dyneema SK75
60 mm. (260 T. M.B.L.)

TUGGER WINCH 1 x 800 m. + 1 x 200 m.
LINES FORWARD wire 54 mm. (210 T. M.B.L.)

LINES AFT 1 x 800 m.

SPARE 1 x 800 m.
wire 54 mm. (210 T. M.B.L.)

DECK EQUIPMENT

CRANE Palfinger PK32080MD 1,3 tons @ 16 m.

TOWING PINS Karmoy hydraulic towing pins.
S.W.L. 200 tons.
Diameter 1.100 mm.

STERN ROLLER Breadth 3.000 mm. S.W.L. 200 T.

SHARK JAWS Karm Fork, S.W.L. 200 T.

NAVIGATION

RADARS 2 x Navi Radar 4000

ECDIS NAVI SAILOR 4000

DGPS 2 x SAAB R4 DGPS

GYROCOMPASS 1 x Anschutz 22 G/GM + repeater

AUTOPILOT 1 x Navis AP3000

ECHOSUNDER 1 x LAZ 5100

AIS 1 x SAAB R4 AIS

DP NAVIS DP I

COMMUNICATIONS

RADIO EQUIPMENT According to GMDSS Area 3

MW/SW Sailor 150 W

INMARSAT - C 2 x Sailor TT-3000EB GMDSS

V.H.F. 2 x Sailor RT 5022 GMDSS Class A

V.H.F. 1 x Sailor RT 5022

PORTABLE V.H.F.'S 3 x Simrad Axis 30

AIR BAND RADIO ICOM IC-A110 EURO

SART 2 x TRON SART

NAVTEX NX 700B

SATELLITE COMMUNICATION KVH FB-500

ACCOMMODATION

CABINS 4 x 1 man cabins / 1 x 4 men cabin

OTHERS Galley / Messroom / Dayroom /
Office / Laundry / etc.

FIRE FIGHTING EQUIPMENT

FIRE PUMPS 1 x 2700 c.m./hr. @ 15 bar

FIRE MONITORS 2 x 1200 c.m./hr. Water/foam monitors

FIREMAN'S OUTFITS 4 equipments

DECK 2 x 4 connections for hoses port
and starboard

DECK SUPPLY

AIR 1 outlet for working air on deck

CAPACITY 3.000 l/min. @ 7 kgs.

ELECTRIC POWER 380 V x 100 Amp.

GENERAL

A.C. Accomodation fully air conditioned

E.C.R. w/ independent a.c.

C.C.T.V. WITH VCR 2 cameras on mast + 1 in main deck
+ 1 in engine room

M.O.B. BOAT Fitted with 25 hp o/b motor. 6 persons

LIFERAFTS 2 x 10 persons Zodiac

SURVIVAL SUITS According with class

OIL BOOM Deck fittings for fixed instalation o/b

SPRAY ARMS 2 x 6 m. with nozzles